

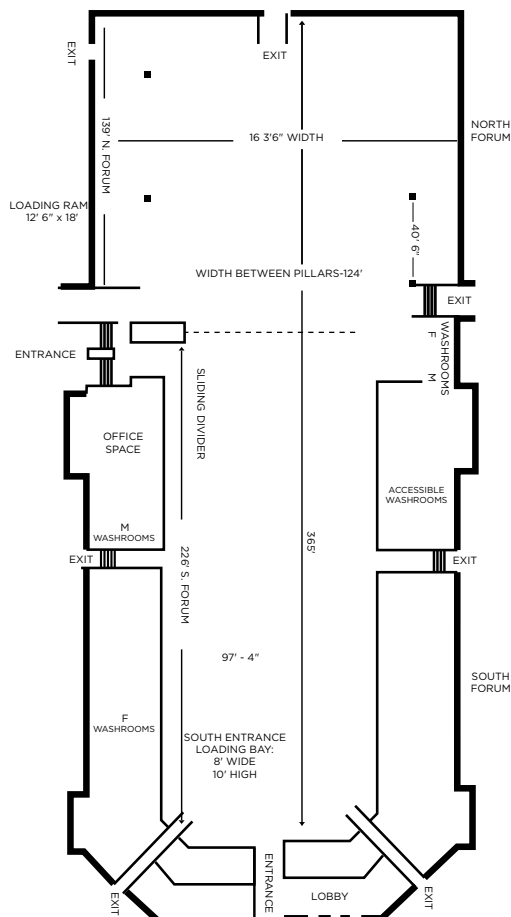

The PNE Forum is a flexible multi-purpose facility of over 44,000 square feet, very popular for commercial shoots due to its 60-foot ceiling (at peak), clear span and ample parking adjacent. The venue is flexible for open space and shoots requiring rigging.

It can be utilized in its entirety or separated into two sections of approximately 22,000 square feet by sliding wall dividers. The building offers multiple dressing rooms to double as storage spaces, break rooms and extras holding.



FILMING RENTAL RATES

Monthly	\$60,000
Weekly, Full Building - 7 days	\$22,000
Daily	\$7,500

Lot 1 included in rental

Minimum of 1 PNE Public Safety/Liaison must be engaged during filming and will be charged an hourly rate for Prep/Shoot/Wrap hours.

The costs of additional services provided by PNE including parking, trades, etc. will be charged in addition to the rental fee.

10% administration fee additional and applied to all charges.

SPECIFICATIONS

Clear Floor Area	44,579 sq feet
Floor Surface	Concrete
West Loading Entrance	12' 6" w x 18' h
Floor to Beams	40'
Floor to Peak	60'

SERVICES AVAILABLE

Shutters can be installed to block the windows from light	\$770 for install/reinstall.
Tie-ins	2 x 400 Amp (3 phase) 1 x 200 amp (3 phase) 2 x 100 am (3 phase)
400 amp	\$400 per day
200 amp	\$200 per day
100 amp	\$100 per day
Tie-In Power Available	\$1 per AMP per day
— 100 AMP, 200 AMP, 400 AMP available	
Water Access for Catering in Lot 1 as required	Discuss with Film Manager

GUIDELINES

- No drilling into floor permitted

Pacific National Exhibition's objective of providing a safe, healthy, secure environment for all staff, clients and visitors to the site is top priority. Compliance with the Worker's Compensation Act, WHMIS, ACTSAFE and related legislation is the minimum standard acceptable.

Keep your crew safe with free and subsidized health and safety resources (ActSafe) www.actSAFE.ca

LOAD POINTS

4,000 lb point load x 7 points

PNE FORUM

