



Film Rate Card PACIFIC COLISEUM



The Pacific Coliseum is the largest building within the Hastings Park complex and provides a magnificent setting for large arena shots, concert scenes, boxing, hallways, corridors and banquet room.

FILMING RENTAL RATES

Daily	\$8,500
Weekly, 7-day rental	\$25,000
Monthly	\$70,000

Minimum of 1 PNE Public Safety/Liaison must be engaged during filming and will be charged an hourly rate for Prep/Shoot/Wrap hours.

The costs of additional services provided by PNE including parking, trades, etc. will be charged in addition to the rental fee.

10% administration fee additional and applied to all charges.

SPECIFICATIONS

Arena Floor (no ice and seats retracted)	56,825 sq feet
Permanent Seating	15,713
Upper Level	37,500 sq feet
North Loading Entrance	20' w x 17'5" h
Floor to Beams	69'
Floor to Score Clock	50'

SERVICES AVAILABLE

Tie-In Power Available	\$1 per AMP per day
— 100 AMP, 200 AMP, 400 AMP available	
IATSE 118 Rigging crew required	
— Rates vary and include payroll benefits and an administration fee.	

GUIDELINES

- No drilling into floors/ceiling
- Pacific National Exhibition's objective of providing a safe, healthy, secure environment for all staff, clients and visitors to the site is top priority. Compliance with the Worker's Compensation Act, WHMIS, ACTSAFE and related legislation is the minimum standard acceptable.*
- Keep your crew safe with free and subsidized health and safety resources (ActSafe) www.actsafe.ca*

LOAD INS

Area:	50' x 60'
Door size:	20'0" w x 17'5" h
# of trucks allowed in bay:	2
Dock/ Bay:	Bay, ramp down from trucks
Push distance to stage:	30'
Fire lane required:	14ft
Case storage areas:	30' x 100'
Misc. load in area notes:	voms available, secondary load in bay (F&B service door 16'0" w x 15'8" h)

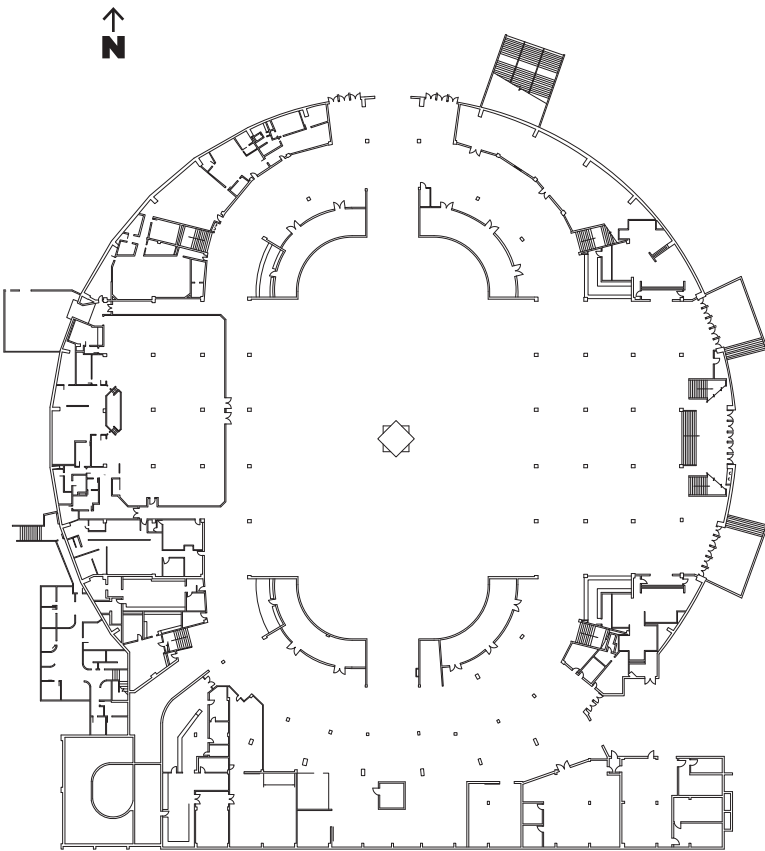

PACIFIC COLISEUM

